

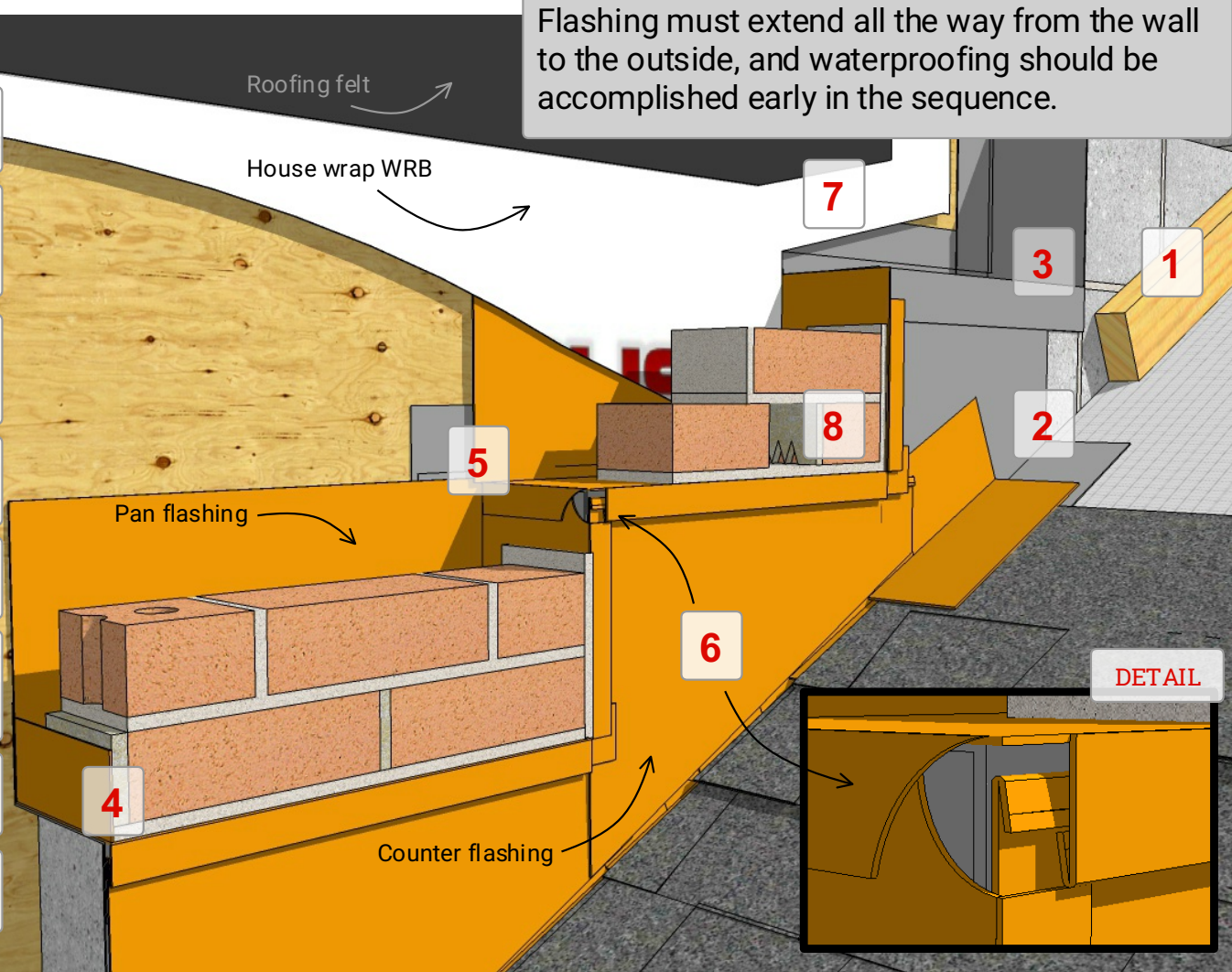

Step Flashing a Roof to a Brick Wall

Flashing must extend all the way from the wall to the outside, and waterproofing should be accomplished early in the sequence.

1. Locate inside corner at least 4 in. above roof deck.
2. Waterproof block and roof/wall gap with peel and stick membrane.
3. Cap the block with membrane extending back to the sheathing and covering
4. Turn the end up on the bottom pan, to kick water out.
5. Subsequent pans have the end turned over previous pan.
6. Counterflashing locks into hook in pan flashing and tucks behind the vertical strip.
7. Two layers of house wrap or felt overlap flashing legs.
8. Weep mesh in every pan allows drainage.



Watch this detail sequence on your phone: <http://goo.gl/5ULbFf>

Sources: International Masonry Institute, BOWA
Technical assistance: Doug Horgan (BOWA), Harrison McCampbell, AIA
Illustration: Daniel Morrison
Copyright 2016 SGC Horizon
www.protradecraft.com